

HYDROTEK ENGINEERS & CONTRACTORS, GHAZIABAD

N – NUT

24° CONE END

AVAILABLE IN CARBON STEEL & STAINLESS STEEL

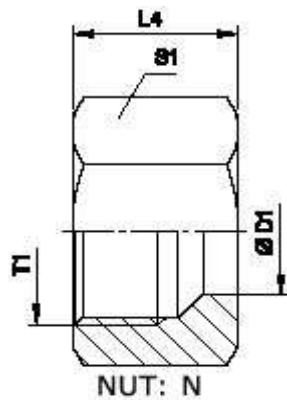

SERIES	DIN2353 SPEC.	D1	L4	T1	S1
LL	N04LL	4	6	M8X1	10
	N06LL	6	7	M10X1	12
	N08LL	8	7	M12X1	14
	N10LL	10	7	M14X1	17
	N12LL	12	7.5	M16X1	19
L	N 06L	6	9.5	M12X1.5	14
	N 08L	8	9	M14X1.5	17
	N 10L	10	10	M16X1.5	19
	N 12L	12	10	M18X1.5	22
	N 15L	15	10	M22X1.5	27
	N 18L	18	10	M26X1.5	32
	N 22L	22	10.5	M30X2	36
	N 28L	28	10.5	M36X2	41
	N 35L	35	13	M45X2	50
S	N 06S	6	9.5	M14X1.5	17
	N 08S	8	9	M16X1.5	19
	N 10S	10	10	M18X1.5	22
	N 12S	12	10	M20X1.5	24
	N 14S	14	10	M22X1.5	27
	N 16S	16	10.5	M24X1.5	32
	N 20S	20	12.5	M30X2	36
	N 25S	25	12.5	M36X2	46
	N 30S	30	13	M42X2	50
N 38S	38	13.5	M52X2	60	