

## **URYU MAKE IMPACT WRENCH**

**Make: URYU, SHINANO**

*Most of the industrial assembly line engineers are still looking for how to control the torque. Concept of torque controlling can be useful on reducing cost and quality control. Controlling torque is absolutely necessary for any assembly operation. However Oil pulse tool provides major advantage over other conversation tools.*

### **What is oil pulse tools?**

*Briefly an impact wrench with an integrated hydraulics system to produce force (or) shock up to the set limit.*

### **Advantages of Oil Pulse Tools:**

- *Productivity: ergonomics benefit can increase productivity*
- *Low maintenance: longer service life due to less wear on parts, only oil ,O-ring, spring or washer need to be replaced to extend the use life .*
- *Repeatability: consistent and accurate performance on properly application, torque Monitoring available for performance verification.*
- *Ergonomics: oil pulse unit brings low reaction force during operation, low noise, low vibration, less wait for operation comfort.*

*Oil pulse tools are available in vide range for various fastening application,different type of shapes ,different torque ranges ,different drives With shut off and Non shut off technology*

- *Straight type– best accessibility on the assembly line, available 1/4”(6.35 mm )Hex anvil,3/8” sqare drive anvil,1/2” square drive anvil, torque up to 130 Nm.*
- *Pistol – easy to access from various angles,sutiabile for most fastening application available in screw driver anvil 6.35 hex and square drive anvil 3/8,1/2”,3/4” From the torque range of 3.5 Nm to850 Nm*
- *Angle – Ideal for Narrow & hard-to-reach applications. only 3/8” & 1/2” sqare drive Anvils available with torque range from 6Nm to 50Nm.*



## **IMPACT WRENCH**

**Make: SS AIRTOOLS, URYU**

*The vide range of SS Air Tools Impact wrenches / Impact screwdrivers offer fast and economical*

operation. High volume heavy assembly application such as Automobile assembly, heavy engineering assembly, car, truck service station, appliance, constructions, special machine manufacturing and so forth.

Impact Wrenches available up to 2300 Nm torque with different square drive Anvils - 3/8", 1/2", 3/4", 1".



### ***Pneumatic Torque Controlled Screw Drivers-URYU***



***Make: SS AIR TOOLS, Uryu, shinano, Mijiland.***

*TORQUE CONTROLLED Screw drivers Excellent for fastening applications such as plastic ,composite or metals, electronic assembly , appliances, automobile components where utmost accurate torque control is required.Screw drivers also offer precise shut –off, reducing torque reaction, and ensuring the operator comfortable and safe operation.*

- Available in straight, pistol and angle type torque range from 0.5 Nm to 28Nm.

# SS AIR TOOLS

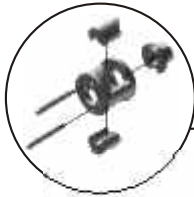

## Wrench list Two hammer Type



SP-100LH 1/2"  
Side exhaust



SP-100LB 1/2"  
Side exhaust



SP-310LB3 3/8"  
Side exhaust

## Impact Wrenches



★ Single Hammer  
SM-401 3/8"  
Butterfly Impact Wrench



★ Single Hammer  
SG-0775 3/8"



★ PN Clutch  
SG-0717 1/2"  
SG-0717L 1/2"



★ Two Hammer  
SG-0752 3/4"



★ Single Hammer  
SG-0705S 1" W/2" ANVIL  
SG-0705L 1" W/6" ANVIL

MODEL	Bolt Capacity	Free Speed (R.P.M.)	Torque (FT/LBS)	Square Drive	Air Inlet Thread (N.P.T.)	Air Hose Size (I.D.)	Ave. Air Consu. (CFM)	Overall Length	Weight (LBS)
SP-100LH	5/8"	3,000	148	1/2"	1/4"	3/8"	8.5	11.81"	6.39
SP-100LB	3/4"	5,000	325	1/2"	1/4"	3/8"	8.5	7.28"	5.07
SP-310LB3	1/2"	8,000	177	3/8"	1/4"	3/8"	10	7.28"	2.89
SM-401	3/8"	10,000	75	3/8"	1/4"	3/8"	3	5-1/2"	2-1/8
SG-0775	3/8"	10,000	75	3/8"	1/4"	3/8"	3	5	2-5/8
SM714T	1-1/2"	7,000	450	1/2"	1/4"	3/8"	4	7-1/2"	5-9/10
SG-0717	5/8"	7,000	380	1/2"	1/4"	3/8"	4.2	7-1/2"	5-9/10
G-0752	1"	6,500	750	3/4"	1/4"	3/8"	5.5	9"	10-1/10
SG-0705S	1-1/2"	3,500	1,200	1"	3/8"	1/2"	12	11-7/8"	26-3/5
SG-0705L	1-1/2"	3,500	1,200	1"	3/8"	1/2"	12	16-7/8"	27-1/10