

QUICK CHANGE TOOL POST WITH MULTI TOOL HOLDERS

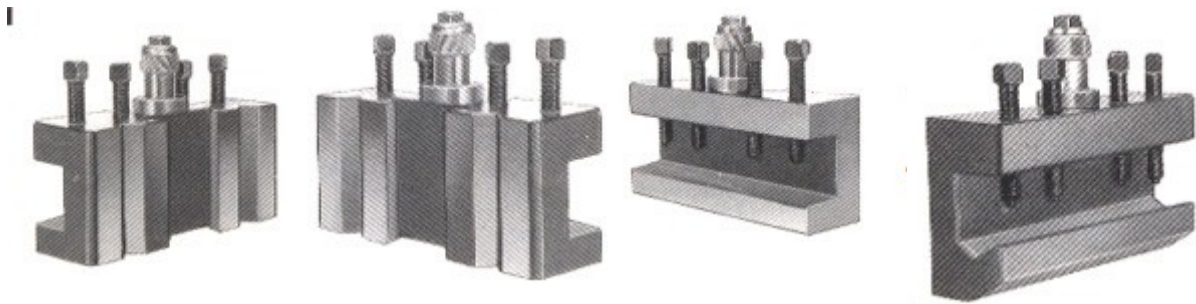
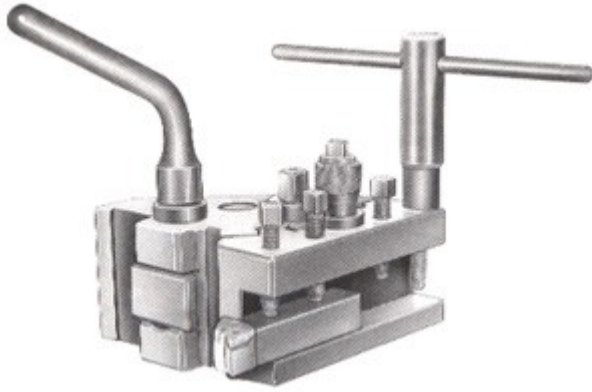

SPECIFICATIONS

Features :

1. Tool changing achieved in split second.
2. Guaranteed Tool Positioning accuracy within 0.005 mm
3. Parts made of alloy steel Hardened and ground ensuring long life.
4. Number of extra operations possible with pre-set tools and special accessories.

SPECIAL ACCESSORIES & SPARES

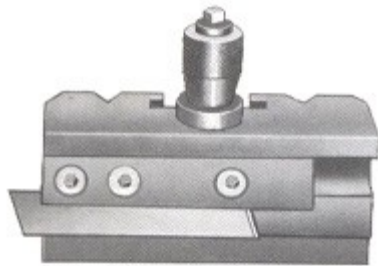

PARTING TOOL HOLDER

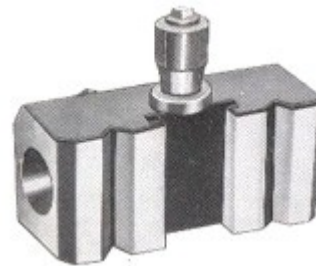

KNURLING TOOL HOLDER

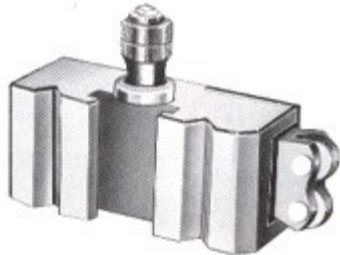

DRILLING HOLDER M.T. BORE

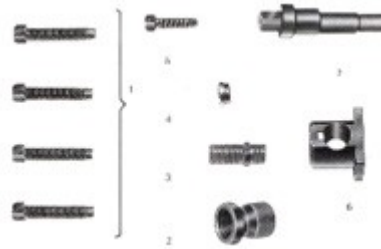

SPARES:(1) M 10 x 50 sq.hd. bolts (2) Thimble (3) Ferrule (4) Washer (5) M 8 x 32 bolts (6) Clamping piece (7) Eccentric pin.

SUITABILITY CHART

H.P. 150	H.P. 210
SUITABLE FOR Kirloskar Hi cut, Madras GD 1 D2, Enterprise 1330, PSG 141, Tiger G.D. Weiler, Energy, GMM2 MMM 170 Series, New Dilip 162mm Model 1 & 2, Ganesh Machines, Anil Model 1 to 4 Lathes Venus HG 31, Venus HG 41, Sukan SU-37 & all 4 1/2 Lathes.	SUITABLE FOR HMT Vikram, Qetkos Chamundi, LB 17, 22, NH 22, 26, NL22, 26, PSG 124, Kirloskar Shimoga, Enterprise 1550, 1675, 1810, 2215, Sagar, Atul No. 1 to 4, MMM 200 series Nagmati, Sharad 1 & 2 Lathes, Sukan SU-41, Venus HG 50 and all similar medium sized lathes.